

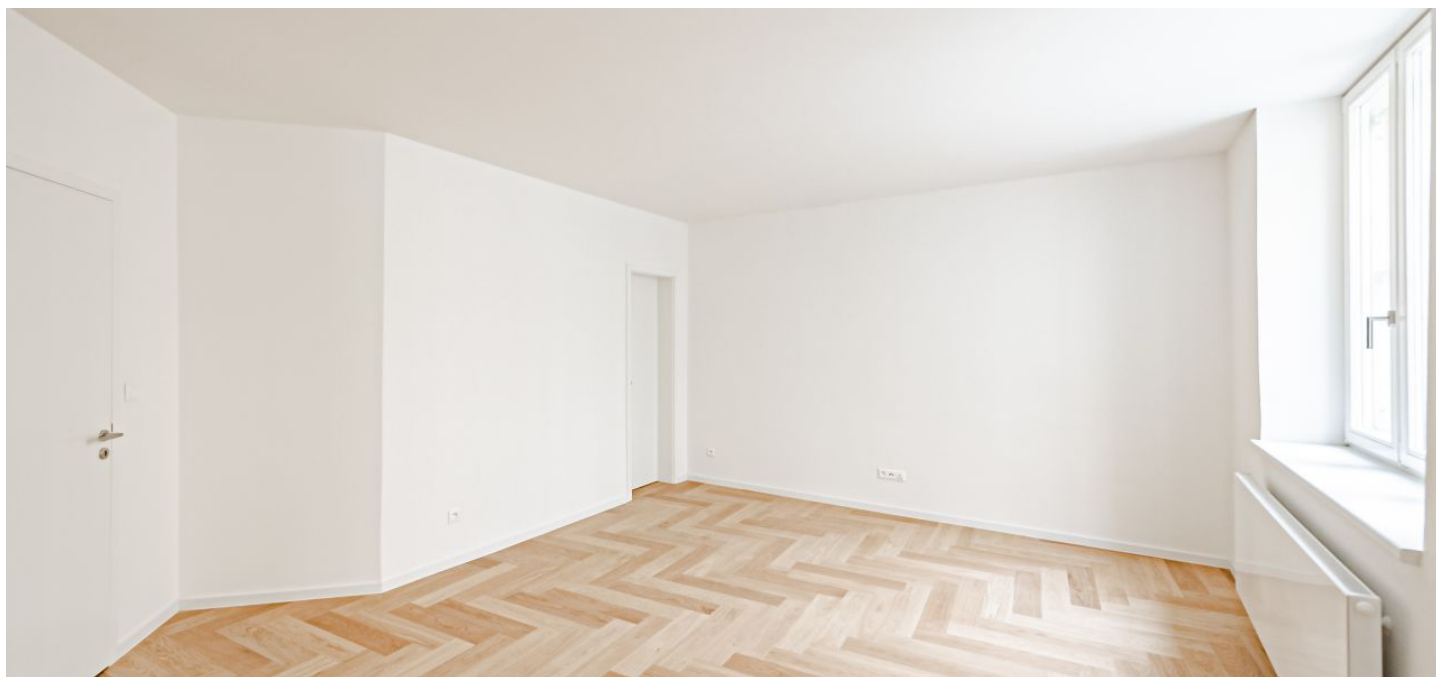

Apartment Studio (1+kk)

43 m², Prague 2, Vinohrady, Londýnská

Sold





Apartment Studio (1+kk)

Sold43 m², Prague 2, Vinohrady, Londýnská

| | |
|------------------|-------------------|
| Total area | 43 m ² |
| Parking | - |
| Cellar | - |
| PENB | C |
| Reference number | 42818 |

This newly reconstructed, high-standard studio apartment is part of a recently completed residence created through the complete reconstruction of a Functionalist building in an attractive location on the border of New Town and Vinohrady district, within easy reach of a full range of services and carefully maintained parks.

The layout of this 1st floor apartment offers a living room connected to a kitchen and dining room, a bathroom, and an entrance hall.

High-standard facilities include **lacquered double-layer hardwood floors in a tree pattern** with a white skirting board, large-format tiles and **Graniti Fiandre** tiles in natural stone decor, Hansgrohe sanitary ware, Vitra bathroom fittings, security entrance doors, **interior doors with concealed hinges**, **plastic or wooden thermal insulated Euro-windows** with double-glazed panes, and a videophone. Heating and hot water are provided by a central boiler. The building has tasteful common areas with original steel windows and a **glass elevator**. It is possible to purchase a **cellar storage unit**.

The area is distinguished by a large number of quality restaurants, cafes, and rich cultural activities. Several schools, including a **Lauder kindergarten**, **elementary school**, and **prestigious high school** are within easy reach. You can comfortably walk to Náměstí Míru Square with the Church of St. Ludmila and the **Grébovka**, **Riegrový**, or **Čelakovského Sady** parks. The I.P. Pavlova metro and tram station is practically right by the building.

Floor area 42.9 m².

* Area of the unit according to the Civil Code. The area consists of the sum total area of the entire unit bounded by perimeter walls.

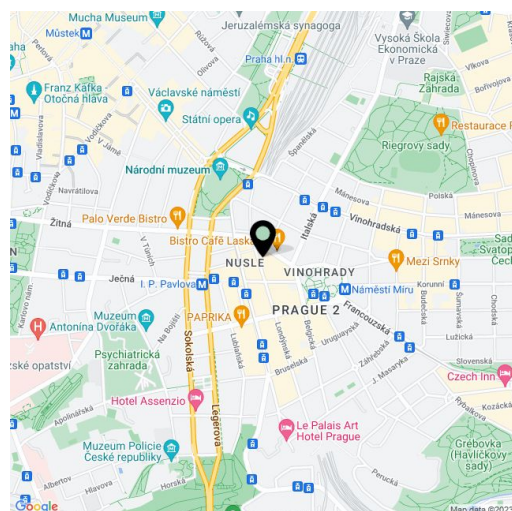



Apartment Studio (1+kk)

43 m², Prague 2, Vinohrady, Londýnská

Sold

UPOZORNĚNÍ: Schéma půdorysu představuje dispozici řešené bytu. Zobrazení vybavení nábytkem, vestavěné skříně, kuchyňská linka včetně spotřebičů a pračky nejsou součástí dodávky bytu. Toto vyznění je zobrazeno pouze pro názornost. Prodejní plocha bytu je vypočtena dle nařízení vlády č. 366/2013 Sp. Veškeré informace jakkoliv publikované v tomto dokumentu jsou nezávazně marketingové obecní povahy, které nelze vykládat jako nabídku na uzavření smlouvy ani se jich nelze dovodávat.

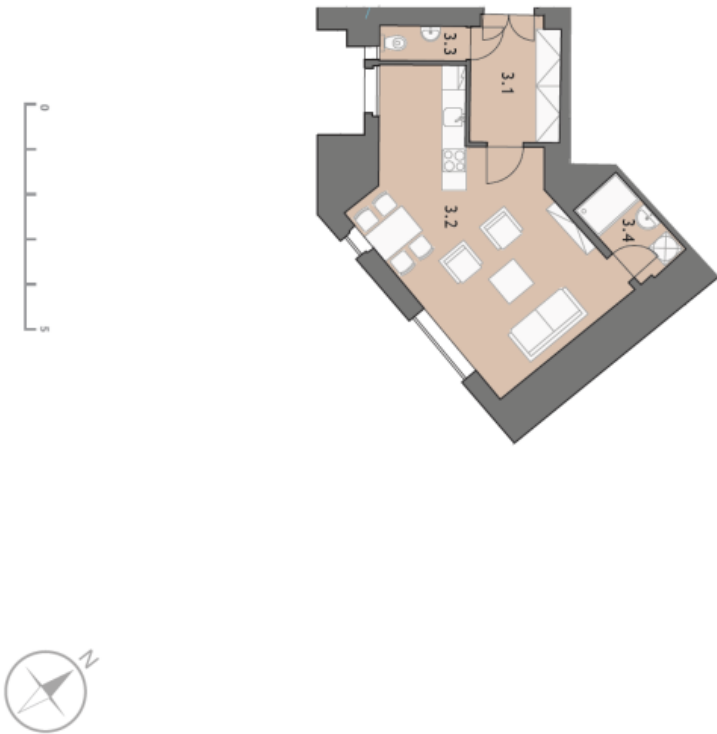

1+kk
DISPOZICE / DISPOSITION

2. NP
PODLAŽÍ / FLOOR

42,90 m²
VÝMĚRA BYTU / FLAT AREA

Byt č. 2578/603

| | | |
|-------------|---------------|----------|
| 3.1 | chodba | 6,99 m² |
| 3.2 | obývací pokoj | 29,47 m² |
| 3.3 | WC | 1,74 m² |
| 3.4 | koupelna | 3,66 m² |
| Plocha bytu | | 42,90 m² |

