

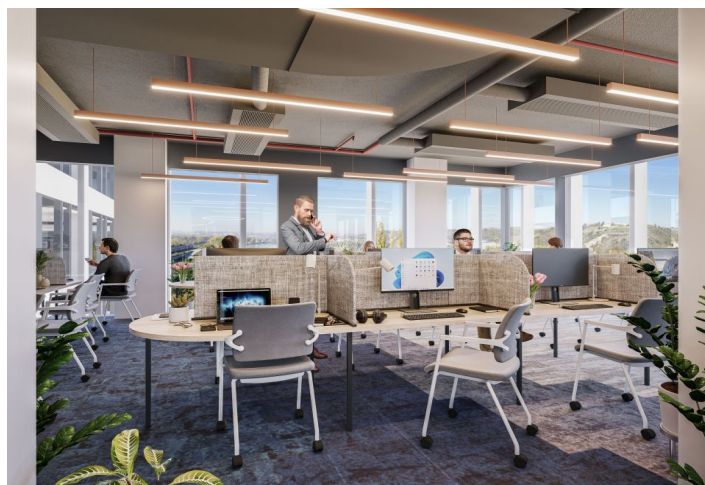

Office building

4 803 m², Prague 7, Holešovice, Partyzánská

Ask for price





Office building

4 803 m², Prague 7, Holešovice, Partyzánská

Ask for price

Total building area	4 803 m²
Tenant consumption	—
Parking	-
Parking service charges	—
Parking ratio	—
Certification	—
Reference number	102777

The inspirational working environment at the Holešovice riverbank harbor will provide you with facilities within shared offices for both individuals and entire teams.

Private offices, hot desks in a **coworking space**, or even your own Office Suite. The **conference center**, accommodating up to 350 people, will provide excellent facilities for your events. All of these options can be offered to you within shared offices in a modern office building.

The campus-style office complex was constructed with consideration for the environment, creating a unique setting for a healthy balance between work and personal life. In the immediate vicinity, a vibrant new riverbank is emerging, offering a variety of leisure activities.

Location:

Excellent transportation accessibility by both car and public transport - in the immediate proximity of the building, there are bus and tram stops. The Holešovice train station and **Nádraží Holešovice metro station (Line C)** are in close vicinity, thanks to a newly built underpass directly from the Nádraží Holešovice metro station.

Shared offices facilities and services:

Daily reception
Mail and packages reception
Accepting phone calls
Business manager services
Services of a head chef
Private café
Equipped private offices
Company headquarters registration and virtual office
Shared meeting and conference rooms
Event space for up to 250 persons
Call boxes
Lounge and shared areas
Fully equipped kitchenettes
Printers and copy center
High-speed Internet
IT help

Equipment and building standards:

LEED Platinum and WELL Gold certifications
24/7 security service
Magnetic cards access
Terrace on the roof of the building
Air conditioning



Office building

Ask for price

4 803 m², Prague 7, Holešovice, Partyzánská

Total building area	4 803 m²
Tenant consumption	—
Parking	-
Parking service charges	—
Parking ratio	—
Certification	—
Reference number	102777

- Sufficient daylight
 - Suspended ceilings
 - Raised floors
 - Storage areas, showers and dressing rooms
 - Restaurant right in the building
 - Parking in underground garages
- Rental and service charges listed without VAT. Lessee pays no commission.